

William N. Lamarre Concrete Products, Inc.
8' DIAMETER DRYWELL
 1000 Gallons per 4' High Ring
 HD Top Loading
 Drawing Not to Scale

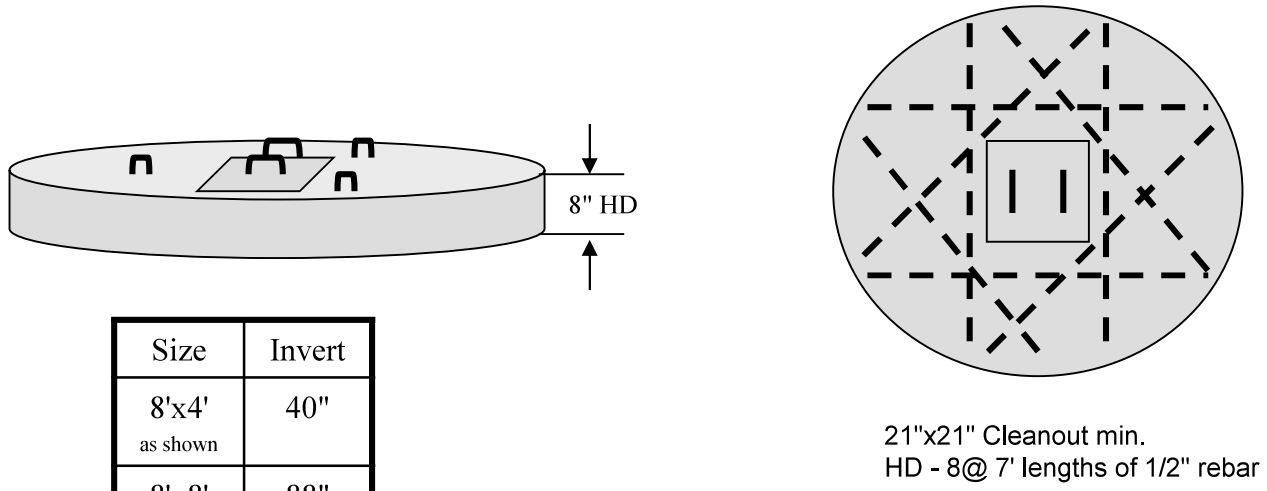

Size	Invert
8'x4' as shown	40"
8'x8'	88"

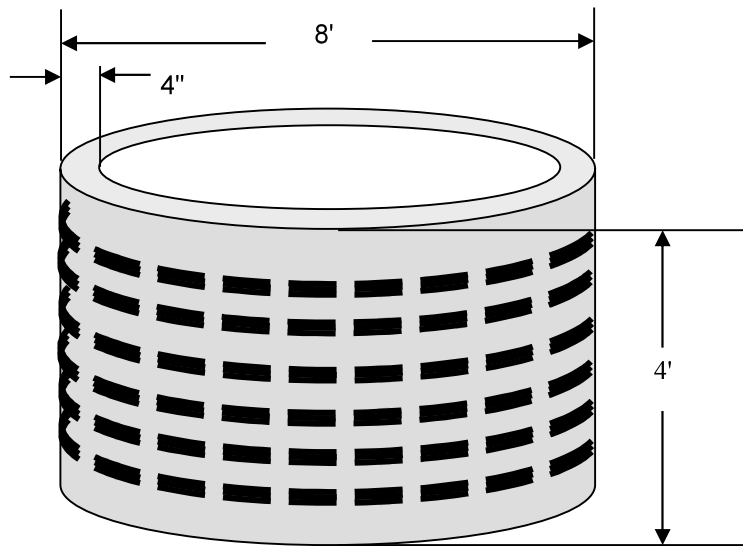

Schematic

Notes

1. Concrete strength f'c 4000PSI@28 days. Density 150 PCF.
2. Cement, Portland Type II or III, ASTM C150-81
3. Admixtures, air & plasticizers per ASTM C233-82.